



32 Portchester Close Park Farm Peterborough PE2 8UP

£1,100 Per month

 2  1  1  D

A two bedroom modern semi detached bungalow located in Park Farm, benefiting from two bedrooms, gas central heating and double glazing. Accommodation comprises modern kitchen, lounge diner, conservatory, two bedrooms and modern bathroom. Ample off road parking to front for several vehicles and garden to rear.



- Hallway
- Bedroom 1 3.30m (10'10") x 2.69m (8'10")
- Bedroom 2 3.00m (9'10") x 2.49m (8'2")
- Lounge/Diner 5.12m (16'10") x 3.03m (9'11")
- Bathroom
- Kitchen 2.49m (8'2") x 2.19m (7'2")
- Conservatory

OUTSIDE
Garden to rear laid to lawn with paved patio area.

Area Map



Floor Plans

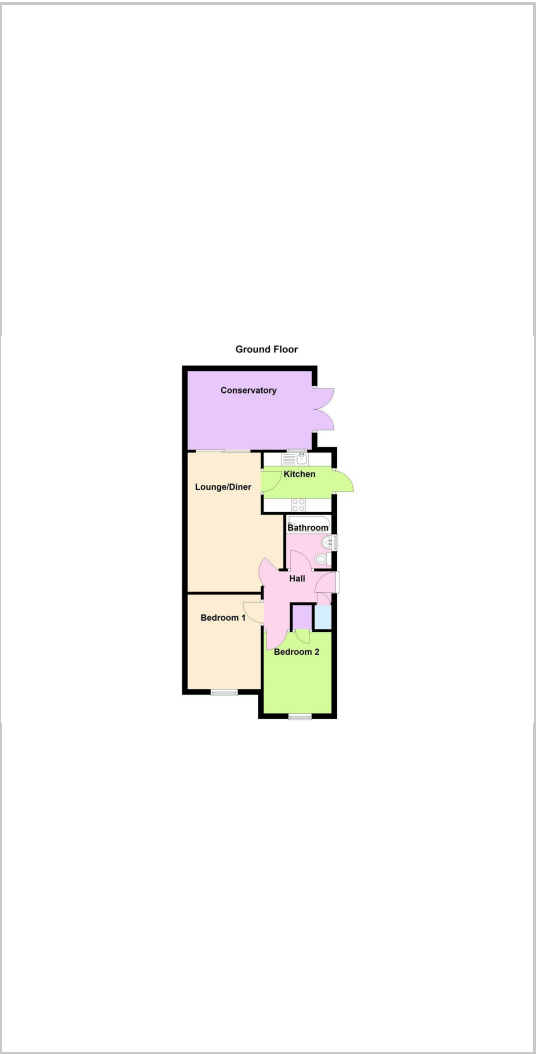

Energy Efficiency Graph

